



# TIME OF TRANSFER INSPECTION TOT# 11792 TERRY KRIEGER CERT # 9027

## Site Information

Parcel Description: **16-30-176-008**

Address: **4681 Summer ST RD, Burlington, IA 52601**

County: **Des Moines**

## Owner Information

Property is owned by a business: **No**

Business Name:

Owner Name: **Sandra kimmel**

Email Address:

Address: **4681 Summer ST RD, Burlington, IA 52601**

Phone No:

## Additional Contact Information

Name	Email Address	Affiliate Type
<b>Tammy kimmel</b>	<b>tjkimmel79@gmail.com</b>	<b>Other</b>

## Site related information

No Of Bedrooms: **2**

Inspection Date: **08/15/2024**

Facility Type: **Residential**

Currently Occupied: **No**

Last Occupied: **07/25/2024**

System Installation Date: **03/12/2012**

Permit issued by County: **Yes**

Permit Number: **c29-7-12**

All plumbing fixtures enter septic system: **Yes**

County contacted for records: **Yes**

Property Information Comments:

## Primary Treatment

### Tank 1 Wilbert

Tank Name: **Tank 1 Wilbert**

Type: **Septic Tank**

Tank Size (Gal): **1250**

Tank Material: **Concrete**

Tank Corrosion Type: **None**

Liquid Level Type: **Normal**

No. of Compartments: **2**

Pump Tank Chamber: **Yes**

Licensed Pumper Name: **Durand Septic**

Date Pumped: <b>8/16/2024</b>	Meets Setback to Well: <b>N/A</b>	Well Type:	
Distance To Well (Ft.):	Is Accessible: <b>Yes</b>	Lid Intact: <b>Yes</b>	
Risers Intact: <b>Yes</b>	Effluent Filter Present: <b>Yes</b>	Watertight: <b>Yes</b>	
Tank/Vault Pumped: <b>Yes</b>	Inlet Baffle Present: <b>Yes</b>	Outlet Baffle Present: <b>Yes</b>	Functioning as Designed: <b>Yes</b>
Tank Comments:			

General Primary Treatment Comments:

Distribution Type

**Header Pipe 1**

Label: <b>Header Pipe 1</b>	Material Type: <b>Plastic</b>	Accessible: <b>No</b>
Functioning As Designed: <b>Yes</b>		

General Distribution System Comments :

Secondary Treatment

**Sand Filter1**

Filter Type: <b>Subsurface</b>	Distribution Type: <b>Header Pipe</b>	Material Type: <b>Rock and PVC Pipe</b>
Absorption Area: <b>480</b>	System Hydraulic Loaded: <b>Yes</b>	Gallons Loaded: <b>130</b>
Discharge At Time of Inspection: <b>Yes</b>	CBOD Results: <b>&lt;2</b>	TSS Results: <b>1</b>
Disinfection Present: <b>No</b>	Disinfection Type:	Tertiary Treatment Present: <b>No</b>
Tertiary Treatment Type:	Meets Setback to Well: <b>N/A</b>	Well Type:
Distance To Well (Ft.):	Sand Filter Probed: <b>Yes</b>	Vent(s) Located: <b>Yes</b>
Saturation or Ponding Present: <b>No</b>	Grass Cover Over System: <b>Yes</b>	Outlet Found: <b>Yes</b>
Sample Taken: <b>Yes</b>	GP4 Permitted:	GP4 Required: <b>No</b>
System Located on Owner Property: <b>Yes</b>	Easement Present: <b>N/A</b>	Functioning as Designed: <b>Yes</b>
Comments:		

General Secondary Treatment Comments:

Narrative Report

TOT Inspection Report Overall Narrative Comments: **Performed load test. It performed good. Tank risers come to surface. Concrete lids and risers. 4" Effluent filter. No critter guard on drain line.**



## TIME OF TRANSFER INSPECTION TOT# 11792 TERRY KRIEGER CERT # 9027

Owner Name: **Sandra kimmel**

Address: **4681 Summer ST RD , Burlington , IA 52601**

County: **Des Moines**

Inspection Date: **08/15/2024**      Submitted Date: **8/25/2024**

**This page certifies a Time of Transfer inspection was conducted and submitted for the property listed above in accordance with Subrule 567 IAC 69.2(8).**

Not to Scale  
Pictures attached

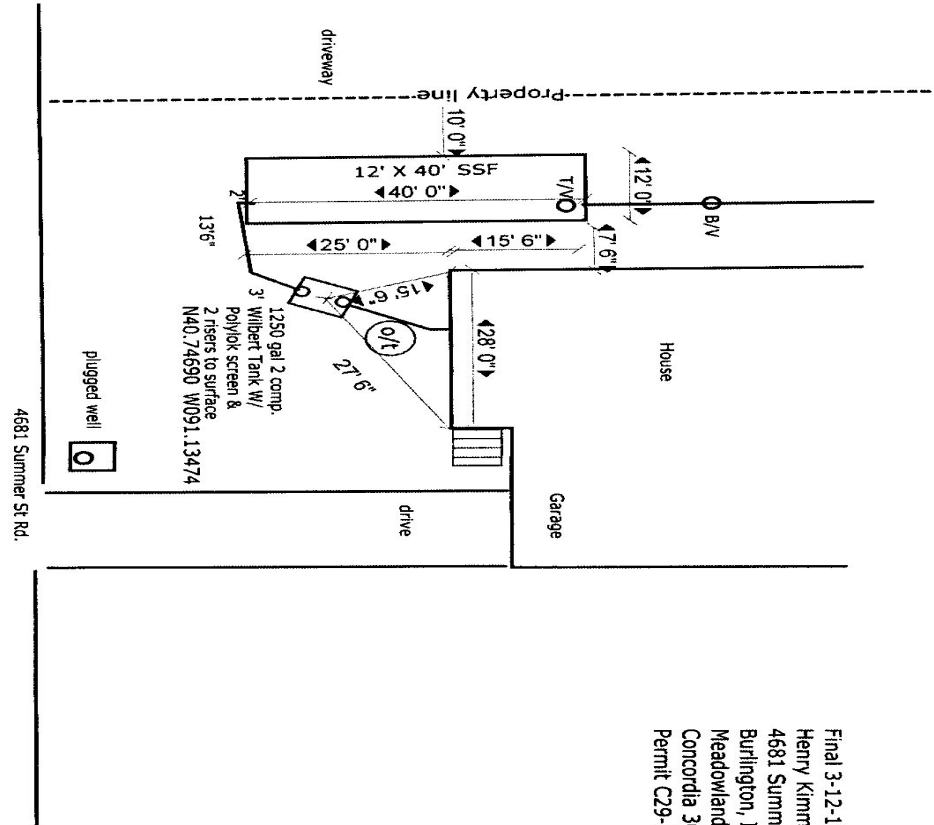

Final 3-12-12  
 Henry Kimmel  
 4681 Summer St.  
 Burlington, Iowa 52601  
 Meadowland Acres lot 4  
 Concordia 30  
 Permit C29-7-12